

TERMS & CONDITIONS

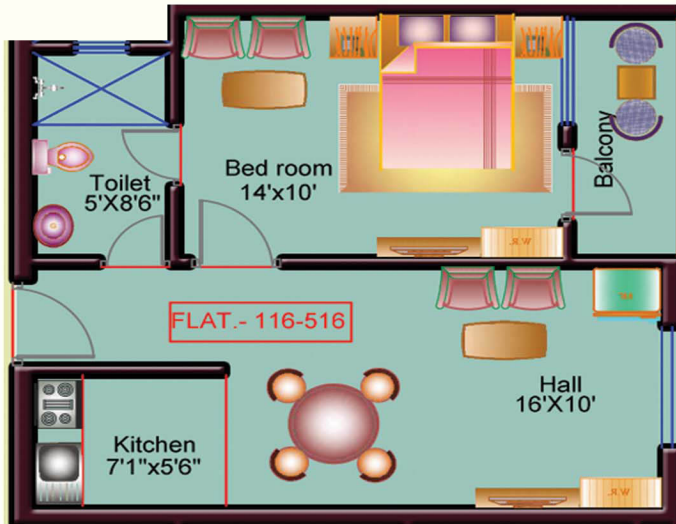

1 BHK Apartment (640 sq.ft.)



The Project is expected to be completed within 24 months.

In case of natural calamities such as (cyclone, rain, earthquake or acts of God) or strike the completion of the flat may be extended from 24 months.

Possession of the Apartment flat shall be handed over to the customers after making full & final payment.

In case of withdrawal after issue of money receipt & allotment letter, amount so deposited towards booking amount shall be refund-ed after deduction of service charges. (i.e 10%).

Shreehari Constructions reserves the right to cancel the allotment in case of default payment or on other reasonable grounds.

Any dispute arising shall be finalized within Puri jurisdiction only.

Payment Schedule

INSTALLMENTS

Initial Booking Amount

% OF TOTAL COST

- Rs. 2,00,000.00

1st installment

on the day of agreement & allotment -20%

2nd installment

on completion of foundation - 15 %

3rd installment

on completion of 1st floor slab - 10 %

4th installment

on completion of 2nd floor slab - 10 %

5th installment

on completion of 3rd floor slab - 10 %

6th installment

on completion of 4th floor slab - 10 %

7th installment

on completion of 5th floor slab - 10 %

8th installment

on completion of brick work - 10%

9th installment

at the time of delivery of possession - 5 % +
society & security charges



Shreehari
Tower

